



Installation Instructions



7" Headlight Visor for Yamaha Royal Star STR-4NK58-10-00

Please read and understand these instructions completely before installation to avoid any injury to yourself or damage to the motorcycle and/or accessory.

DEALER:

These instructions contain important information for future reference and must be given to the customer.

TOOLS REQUIRED:

1 - #1 Phillips Screwdriver

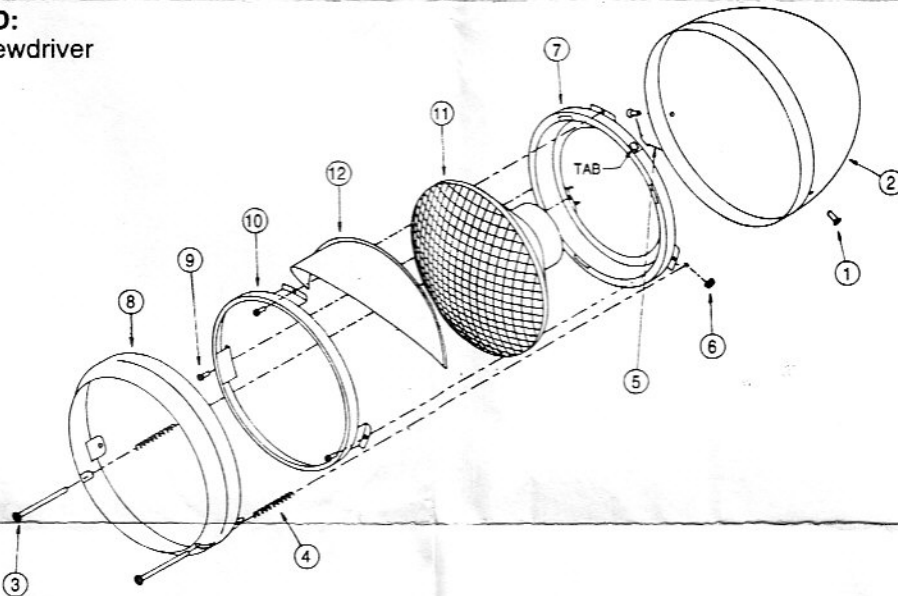

INSTALLATION:

1. Prior to removing headlight, position bike upright about 15 feet from a wall, turn headlight on, and mark spot from beam on wall. Then remove headlight without moving bike, so that mark on wall can be used to aim headlight upon reinstallation.
2. Remove headlight lens unit by removing 2 flathead screws (item 1) on side of headlight body (item 2).
3. Remove panhead screws (item 3), noting location of wire clip (item 5) inside headlight rim and length of screw thread protruding through adjusting nuts. Wire clip, screws, springs and adjusting nuts (items 3, 4, 5, 6), which will all be loose upon removing item(s) 3, should be saved for reassembly.
4. Remove retaining ring screws (item 9) and save. Slide visor (item 12) between retaining ring and lens assembly (items 10, 11), positioning as in illustration. Make sure lens indexing standoffs cast into lens engage recesses in headlight rim mounting ring (item 7). Install retaining ring screws (item 9), position Royal Star logo centered on word "TOP" cast into top of lens surface and tighten screws.
5. Install mounting ring assembly (items 7, 10, 11, 12) into headlight rim (item 8), aligning tab for wire clip (item 5) so that it fits hole in tab in headlight rim. Install wire clip removed in step 3 in noted position, then carefully install springs between mounting ring and headlight rim while inserting screws (item 3) through rim, spring and mounting ring. Thread screws into adjusting nuts (item 6) approximately as far as when removed in step 3.
6. Install headlight lens unit back into headlight body (item 2) and install screws (item 1).

Turn headlight on and use adjusting screws to aim headlight at mark on wall to reposition beam as before disassembly.

CARE AND CLEANING:

Refer to your owner's manual.

CUSTOMER SERVICE:

See your Yamaha dealer.

DATE: Jan. 96
680760

PAK-4NK58-10-00